



April 2015 - Volume 3 - Issue 4

In This Issue

Thoughts from the Superintendent	1	Events of Interest	11
What Happened Last Month	2	New Members and Renewing Members	12
Presentation/Workshop Schedule	4	Wasatch Rails 2015 Update	13
Division Operations Group News	6	2019 NMRA Convention News	14
Notes From the Golden Spike Club	7	Help Promote the Division	15
Achievement Program	7	Treasurer's Report	15
Who We Are	9	The Club Car	16
Member Benefits & Discounts	9	Division Officers and Volunteers	17
New Division Rolling Stock	10	Meeting Information	17

Thoughts from the Superintendent



We're now at a full 4 months into the new Northern Utah Division. So far the track is flat & straight. In fact, at this point, it feels like we're on welded continuous rail. Thanks to everyone for making this happen. Of course, I have a few things for you to consider:

Firstly, Kudos to Stan Jennings, Rick Luther and Pete Harmon for our ongoing clinics, this excellent newsletter and our terrific layout tours. Don't miss Guil Rand's Great Northern Pacific this month. You will not be disappointed!

Secondly, I'd like again to address the issues of membership and event attendance. Our attendance continues to crawl up albeit very slowly. I again ask for your input as to what you want presented at the events. One minor complication is that to attend the Division events and activities, one must be an NMRA member. This can be RailPass if you qualify, but you must join the NMRA. This is all about the requirements from the NMRA insurance carriers. We'll continue to allow one trial attendance, but you will then have to join.



Thirdly, the NMRA is an organization which is mostly made up of volunteers. There are huge opportunities to volunteer for any number of activities. Ideas include getting your layout shaped up and hosting a DOG session, volunteering for one of the many positions on the 2019 Convention committee, doing an Event Clinic, helping a fellow member on his layout, volunteering for the Wasatch Rails 2015 train show committee, and on it goes. There are a great number of other opportunities. Please check them out. And speaking of volunteers, a big thank you goes out to Robert Arnesen for volunteering to be our new Division Librarian.

As Charlie Getz so well states, "Well, those are my thoughts, what are yours?"

Jack Chase
Superintendent
Northern Utah Division of the NMRA
801-323-1148
jack.r.chase@gmail.com

What Happened Last Month



The March 21st, 2015 event of the Northern Utah Division featured an historical presentation from Stan Jennings on the Eureka Hill Railroad.

The Eureka Hill Railroad is one of the more interesting railroads in Utah. Stan covered some background about the founder Jesse Knight and how the Eureka came into existence. The history of the Eureka Hill Railroad and the Tintic Mining District that was the second richest mining district in Utah. It was only surpassed by the Kennecott open mine. Stan explained all about the locomotives and unique rolling stock that served the mines. Included were all known photos of the railroad as well as some of the surviving bits of the railroad that may still exist today. We received a very thorough education in mining basics and mining terms. Stan concluded the presentation with ideas about modeling a mining railroad and mining related rolling stock.



During the "Show and Tell" portion, one of the "O Scale Guys", Al Badham brought a unique early era hopper car that he is working on. The main body of the car was constructed using the new 3D printing method to achieve the intricate curves of the hoppers. Stan Jennings also had an HO scale version of the hoppers for comparison.

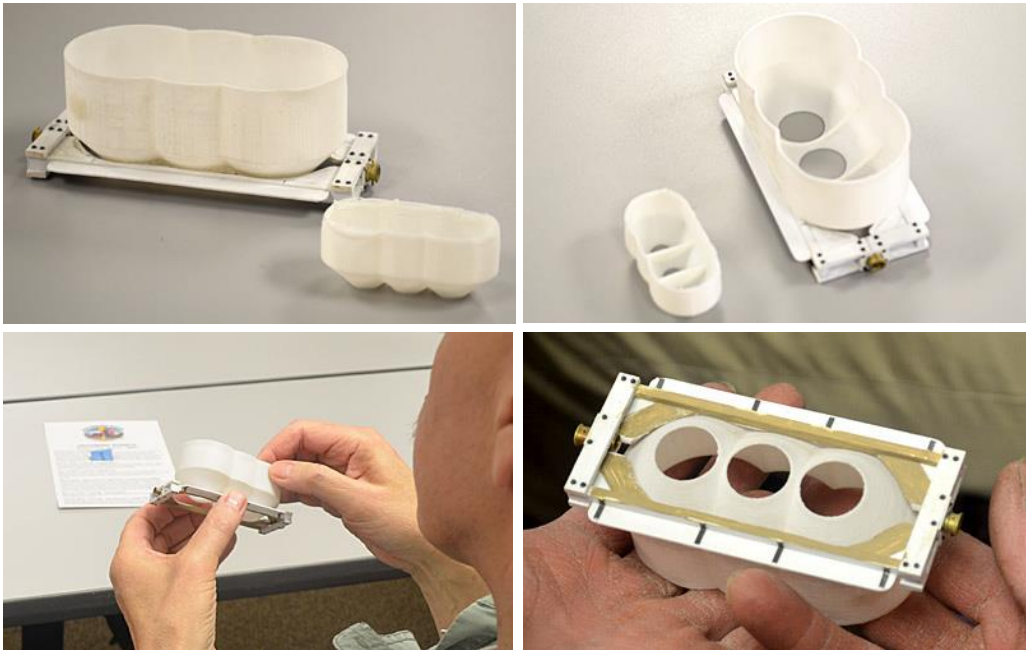

As part of the Division Operations Group (DOGs) "Double Dog Dare" Weekend, I participated in the operating session at Willard Johnson's Jordan Valley Central Railroad. I can not encourage the members of the division enough to get on the DOG's crew call list and take the opportunity to operate at the various layouts. The owners of these layouts are very patient and very willing to help any newbie's learn how to operate on their layout. I would like to give a special thank you to Willard as my mentor the first time I operated on someone else's layout. He was very patient with all the mistakes I made. **Thanks Willard!**

Rick Luther





April

18th

3:00 PM - 5:00PM

Electrify Your Scenery

Presented by Rick Luther

Learn how to build your own static grass applicator from just a few easily available parts and for under \$10.00! Then learn the about the materials, tips and tricks to bring realistic grass to your layout. Be there to win one of two static grass applicators to given away at the end of the workshop!

May

9th

10:00 AM - 5:00PM

UNION STATION HERITAGE FESTIVAL (National Train Day 2015)

At the Ogden Union Station. Come and volunteer and have fun while helping to present displays and programs of interest to the public, especially kids. In years past we have had cardboard cut-out buildings the public could build. Bring and build modeling, where people could watch as we build a project to display some of our modeling skills and answer questions. A Timesaver Switching puzzle for kids of all age to to operate trains and learn about the challenge of switching. We'll be there from 9:00 AM to 5:00 PM, so stop by and enjoy the festivities!

May

16th

3:00 PM - 5:00PM

Presentation

The Legacy of the Golden Spike; Railroad service in Utah

Presented by Dan Kuhn - UDOT's Railroad & Freight Planner

This presentation examines the evolution of railroad service in the Beehive State with a focus on locomotive development and operations. Retired railroad official and current UDOT Railroad & Freight Planner Daniel B. Kuhn uses his own photos to take you on a journey that explains how the railroads serving Utah have been at the forefront of locomotive development, and how post-deregulation railroad mergers have reduced the number of Class One railroads operating in Utah from four in 1980 to the Union Pacific today, with BNSF Railway also serving Utah via trackage rights over selected UP lines. Daniel will share personal anecdotes about his years railroading in Utah and across the west, along with some humorous stories about how some of the photos in this presentation were taken by him. Railroad historians and model railroaders should enjoy this colorful look at Utah's railroads. *All Aboard!*

June

20th

3:00 PM - 5:00PM

A Special Two Workshop Presentation

Making a Mountain

Presented by Ron Davies

Did you see Ron's scenery workshop at Wasatch Rails 2014? The public loved it!! Now we will have a chance to make our own mountains!

Airbrushing

For those who couldn't stay for the entire December basic painting workshop or those who desire more instruction and/or practice, we will also have another painting workshop this month building on the December basic painting workshop.

We will meet at Blaine Holbrook's home this month.

July

18th

3:00 PM - 5:00PM

Presentation and Workshop

Trucks and Running Gear

Presentation by Fred Baney

Find out which trucks are appropriate for the era and type of rolling stock you are modeling.

Properly installing couplers and fine-tuning rolling stock

Workshop by Fred Baney

Learn tips and techniques for fine-tuning your rolling stock so that it performs better on your layout. Bring your "Problem" cars to the event and get them off the "rip" track and back in service.

August

15th

3:00 PM - 5:00PM

Presentation and Workshop

Military Railway Guns

Presentation by Paul Betts

Basic Machining

Workshop by Bill Kennedy

September

19th

3:00 PM - 5:00PM

Presentation and Workshop

Scale and Gauge

Presentation by Stan Jennings

Learn about scale and gauge and how to determine correct scale.

Backdrops

Workshop by Steve Moore

This workshop will cover airbrush painting of sky and clouds, painting trees, commercial backdrops, custom printed backdrops (with or without a sky) and combination painted sky with a printed backdrop. There will be lots of examples, how to videos clips, and more, including an extensive handout.

October

17th

3:00 PM - 5:00PM

Workshop

Hands-On Weathering

Presented by David Seely

November

21st

3:00 PM - 5:00PM

Presentation and Workshop

Modeling Promontory Summit

Presentation by Ron Davies

Quick and Easy Trees

Workshop by Karin Gerald

December

19th

3:00 PM - 5:00PM

Workshop

Mold Making and Casting

Presented by Jim Wanlass

We will meet at Blaine Holbrook's home this month.

Division Operations Group News



In March, the DOGs executed the very first "Double DOG Dare." This momentous event was held at the layouts of Willard Johnson and Bob & Karin Gerald. What was involved was running 2 simultaneous ops session. With the exception of there being a few no shows which really complicated the sessions, things went relatively smoothly. The major lesson learned-- hopefully by everyone--is that if you commit to an operations session, you are committing to be there. At the very least, you do owe the Host and the Crew Chief a communication stating that you cannot make it and giving as much notice as is possible!



On April 25, the DOGs will be returning to Rob Spangler's Western Pacific layout for a fun filled day. Be sure to mark up early as the open positions are limited to 9 crew. Come and see the improvements Rob has made to his layout since our last session there.



To be a participant in the Northern Utah Division DOG program you must be a current NMRA member. RailPass membership is, of course, acceptable. This is required so that our insurance requirements are met. The Host and his assistants do not have to be NMRA members.

Regards,

Jack Chase
Crew Master -- DOGs
Northern Utah Division -- NMRA
Host of the 2019 NMRA National Convention



Saturday, April 18 from Noon to 6:00 PM

We are having an open house of our layout at 840 North Beck Street in Salt Lake City, Utah. Everyone is invited!

Club Hours have changed from 6-9 on Saturdays to 3-6 P.M. We hope this will work out better for everyone!

We have several trains in the Trains for Tots Christmas program that need minor repair. Volunteers are needed

Achievement Program



Have I mentioned I sometimes like to jump from project to project before finishing? Well, it seems like I've been waiting a long time for a few detail parts so I could finish my Cars Certificate. In the meantime, I received a kit I've been waiting on for a very long time. This kit will help with a couple other certificates so I decided to work on the main building. It felt good to get back working on a building. After a few days of really getting into it, guess what came in the mail? If you guessed those detail parts, you were right! I couldn't believe it, after waiting so long and finally really switching gears, they showed up! Anyway I worked a couple more days on the building until I was at a somewhat decent spot for taking a break from it. Now, it was back to working on those cars.



I don't mind jumping around a bit but sometimes when you are in a good groove you want to stay at it for awhile. Well, I know I'll get back to that building soon but I have to finish up the last details on these cars. Four have to be scratch-built and they were mostly done. I was waiting on some trucks and the final detail parts for the brakes. I need eight for a different project (which I will describe here in a future article.) For now, though, I just need to finish those four, plus the dreaded passenger car requirement.

I didn't ever think of it as a big issue but I guess some people don't like passenger cars? Nearly every railroad had them so it makes sense to include it as part of the requirements. Besides, one of them main reasons for the Achievement Program is to help make us well-rounded modelers. If I don't like passenger cars, it gives me a chance to expand my horizons and build at least one. Personally, I like passenger cars but had to figure how I was going to handle this requirement. I had nearly finished a scratch built Camp Car some time ago. Could I use that? The answer was no, not really. A Drover's Caboose could be used but I didn't already have one of those. Since I didn't need another scratch built car I decided to check what kits I had already.

I found a couple of passenger car kits in my supply of un-built kits. Now came the decision of how to super-detail it to qualify for more than just putting together a "blue-box" kit. The easiest answer is to detail the interior. I looked for pictures on the Internet as well as recalling my experiences riding old-time coaches. I found a set of unpainted figures that came with benches. Painted right, the benches could work for seats inside the car. How about adding lighting to the inside so one could see the work I've done? I'd have to update the wheels, which I do anyway to all my kits, so I could have electrical pickup. All of that, plus adding glazing to the windows (It was such a simple kit it didn't even include window glass!) gave me plenty of work to enhance the kit to be a fine piece of rolling stock.



My son was surprised at how quickly I painted the people.

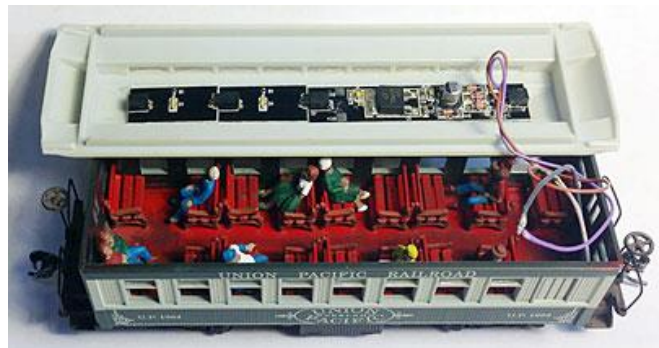

Adding lighting and people can really enhance a simple kit.

I can see the light at the end of the tunnel! As I am wrapping up finishing my cars, the one major thing left is the paperwork. Well, I've taken photos along the way and that helps me remember some of the details to include when filling out the paperwork. It really isn't that big of a deal but I think people get bogged down in the fact that they have to do it. It's really just one more step to do that isn't even as hard as building a model. I think part of the problem is that people would rather be building a model than filling out paperwork and that's the real issue.

Speaking of paperwork, I'd like to congratulate Jack for finally finishing his Golden Spike Award! I believe he, like so many of us do, get bogged down in the details a little too much. I'm sure if you ask him, he will say it wasn't that hard. I know for a fact that he feels great to have it finally done! I know that feeling, Jack! It's good to have smaller goals to help reach that big one. Hopefully I'll have your certificate back from the Region in time for the next Division Event so I can present it to you. I know I'll be watching for your name in the next issue of the NMRA Magazine. I know that with Jack, he for sure can say that we can enjoy the journey together!

Jim Wanlass
AP Chairman
ap@northernutahnmra.org

Who Are We?



Let People Know Who We Are!



We all have a fantastic opportunity to let people know who we are. Ok, you say. Years before Disneyland opened its door to "children of all ages", Walt let people know the progress on his new big idea, the world's first big scale theme park. He built enthusiasm for what was to come. He single handedly wet the whistle of his would-be customers, a ready-made sure fire success for opening day, and years to come.

We can do much the same thing by adding a little phrase to our E-Mail signatures, submitted articles to the Promontory Post, R.M.R. Callboard, NMRA Magazine, Model Railroader Magazine and others:

"Northern Utah Division, NMRA and Host of the 2019 NMRA National Convention".

We can peak interest and awareness of the 2019 Convention being in our own backyard. It's not too early to make this known, and it's not hard to do. Take a tip from Mr. Disney, YOU CAN DO IT!

Steve Moore
Northern Utah Division, NMRA,
Host of the 2019 NMRA National Convention

Member Benefits and Discounts



Northern Utah Division NMRA Member Benefits and Hobby Shop Discounts

The Northern Utah Division, NMRA's Wasatch Rails 2015 will be offering some special benefits for NMRA members. In a few days we will be sending a separate mailing with the complete information to NMRA members.

Hobby Shop Discounts



The Train Shoppe offers a 5% club discount, NMRA members can take advantage of this discount by showing the NMRA membership card. However, The Train Shoppe also offer a card program that offers a 10% discount, any customer is eligible for the card discount.

2964 South State Street | Salt Lake City, Utah 84115 | 801-322-2729 | Open 10am-7pm Mon-Sat



MRS Hobby Shop offers a points system discount, ask them for details.

9860 South 700 East | Sandy, Utah 84070 | 801-572-6082
Monday - Saturday: 10 AM-7 PM | Sunday: Closed

New Division Rolling Stock



The Northern Utah Division produces cars as fund-raisers. The Division has no dues (other than being a NMRA member) and by doing special limited-run cars (usually only 48) it helps raise money for our activities and events.

The 2015 Northern Utah Division Club Car is a Fisher Beer reefer fantasy car based on logos from an actual Fisher Beer bottle dating to the 1950s-1960s. An Accurail 8500 Series 40' Steel Plug Door Refrigerator Car will be used. There will be only 48 cars produced. We recently received the final proofs for the car from Accurail.



Get your name on the list to reserve one soon! Thanks to Steve Moore, the car has been featured in the April 2015 edition of the Model Railroad Hobbyist magazine so we don't expect the car to last long! There are only 26 cars available.

...shows each year and they are more than qualified to represent ExactRail at these events ...

NEW CLUB CARS



NMRA Northern Utah Division, home of the 2019 National NMRA Convention, is selling a custom kit for a Fisher Beer Car.

The HO scale kit is based on an Accurail 40' steel refrigerator car with Dreadnaught ends and plug doors. This is a limited-edition custom model with only 48 kits scheduled to be produced. They are available at \$40.00 each plus \$5.00 shipping from Stan Jennings, 5412 Colter, Kearns UT 84118. For additional information call Stan at 801-967-0999 or visit northernutahnmra.org.

NEW PRODUCTS FOR ALL SCALES

To reserve your own car, contact Stan Jennings at 801-967-0999 or order online from the division website at <http://northernutahnmra.org/club-car/>

Events of Interest



What follows is a list of railroad-type events that may be of interest to all you train nuts.



May 2nd 2015

Model Railroad Estate Auction

Saturday, May 2, 2015 there will be a model railroad estate auction, (three different estates) at the Comfort Inn in Ogden, 1776 West 2550 North. Plan on it, there will be lots of great items available.



May 9th 2015

Ogden Union Station

UNION STATION HERITAGE FESTIVAL (National Train Day) will be held on Saturday, May 9th. Train enthusiasts and supporters around the nation celebrate National Train Day each year at hundreds of locations across the country! The Northern Utah Division, NMRA, will have a presence at the festival with boxcar races, timesavers and more!



May 15th - 17th, 2015

2015 Sherman Hill Annual Model Railroad Show

Frontier Park Exhibition Hall

Friday 5PM - 9PM
Saturday 9AM - 5PM
Sunday 9AM - 4PM

\$10 for adults, children 12 and under free, includes admission to all venues.



Sept. 2nd-5th, 2015

35th Annual National Narrow Gauge Convention Houston, Texas

One does not have to be a dedicated narrow gauge fan to enjoy a National Narrow Gauge Convention, there are enough activities and opportunities for learning and making new friends that anyone will enjoy the experience. The 2017 convention in Denver is the important one, it is relatively close and participating in a National Narrow Gauge Convention will give us excellent insight into what is involved in our upcoming National NMRA convention. And National Narrow Gauge Conventions are just total fun!

November 6th - 8th 2015

**Wasatch Rails 2015 The Utah Model Train Show
Utah State Fairpark**



Friday 3PM - 8PM
Saturday 9AM - 6PM
Sunday 10AM - 4PM

Contact Stan Jennings : 801-967-0999 or
Blaine Holbrook : bholbro1467@earthlink.net



Rocky Mountain Express

Rocky Mountain Express propels audiences on a steam train journey through the breathtaking vistas of the Canadian Rockies and highlights the adventure of building a nearly impossible transcontinental railway. Recruited to realize this venture—one of the greatest engineering feats of all time—were engineers and laborers from around the world.

The film weaves together spectacular IMAX aerial cinematography, archival photographs and maps, and the potent energy and rhythms of a live steam locomotive to immerse audiences in this remarkable story from the age of steam. 40 Min program shown multiple times daily

clarkplanetarium.org/shows/rocky-mountain-express/

New Members and Renewing Members



**Please renew your membership when it comes due.
We value your talents and friendship you bring to the party.**

The Region has just narrowly averted a disaster, in that our insurance coverage was missing since the first of the year. Thankfully it has been reinstated. How did this happen, you might ask. Simple, too many participants at division, regional, and 100% NMRA member clubs who were either not members, or had lapsed membership. Policy is that if one is in a leadership position, and one lets their membership lapse, they are to be removed from office until such time as their membership once again is current. Guests (non-members) are allowed to attend 3 events, after which they are required to become members in order to participate in any further events. Simple rule of thumb, if you aren't a member, don't expect to be allowed to partake of any member benefits or to be able to join in any reindeer games. To help us all keep in the good graces of the NMRA, you can expect a friendly reminder from the Membership Committee 60 days and 30 days before your membership expires.

How does that saying go? At PC Laptops, we love you! Your fellow NMRA-NUD members, we LOVE you!



Membership Application and Renewal

Join the NMRA and enjoy the many benefits of membership.
Want to "test drive" the NMRA for a little while?

Sign up for our 6-month Rail Pass trial membership for only \$9.95!
Includes 6 months of NMRA Magazine, plus all regular member benefits
(except voting).

<http://www.nmra.org/membership-application-and-renewal>

Wasatch Rails 2015 Update



As of April 11, 2015 about half of the layouts have committed, we are still waiting on others. Vendor tables on the Grand Main are close to sold out.

About half of the layouts are committed, we have a verbal commitment from Lego, Geoff Carter is re-contacting others.

We have a maximum of 120 tables available for all three areas.



2019 NMRA Convention & Train Show Location



The Northern Utah Division's National Convention Organizing Committee (SLC2019) is looking for some talented model railroaders and organizers to help us plan the 2019 National Convention in Salt Lake City in July of 2019. Some committee members will be members of the National Model Railroad Convention Committee. (NMRC)

The Northern Utah Division Host Committee (SLC2019) has primary responsibility to recruit local clinicians, as well as coordinate with the NMRC for national clinicians, Modeling with the Masters, EduTRAIN™, non-rail tours, layout tours, and prototype tours among other things. Generally, all things outside of the convention hotel fall under the responsibility of the SLC2019 Host Committee...that's us in the Northern Utah Division.

We are actively looking for volunteers for the following positions:

Immediate needs: (by March 31, 2015)

Host Committee Clinic Chair – This person helps secure local clinicians for the convention and is a member of the National Model Railroad Convention Committee (NMRC) and the Host Organizing Committee (SLC2019.) Other Clinic committee members may assist this chair. This person helps organize the daily clinic schedule of both national, and local clinicians with the NMRC. Includes contacting potential clinicians, finding needs (A/V, etc.), secure their clinic and communicate with the National Model Railroad Convention Committee. Closer to the convention this person will assist the NMRC in providing content for the printed timetable.

Host Committee Non-Rail Tours Chair – This person secures non-rail (general interest) tours for the convention and leads the Non-Rail Tour Committee. This person is a member of the National Model Railroad Convention Committee (NMRC.) This person leads a committee to identify and organize daily trips to sites of general interest during the convention. This includes contacting tour sites, securing dates, finding out the maximum number of attendees per tour, pricing, etc. Tour bus needs and contracts are handled by the NMRC. Closer to the convention this person will assist the NMRA in providing content for the printed timetable.

Host Committee Tours Chair – This person secures all tours that are rail related. This includes layout tours, prototype tours (UP, UTA, BNSF, Utah Railway, etc.) This person will coordinate with the Non-Rails Tour Chair. This person is a member of the National Model Railroad Convention Committee (NMRC) and will participate with the NMRC. This person organizes and secures daily tours to sites of railroad related sites including layout tours. Contact has already been made with Union Pacific and UTA. There is an expectation of signing up 40+ layout tours around the Wasatch Front.

Committee members – If you feel you know contacts and are willing to make calls and send and respond to emails, you may wish to sign up to assist on one of the above committees. If you have any questions, please contact the SLC2019 Convention Chair, Alan Anderson at 801-965-6640 or alan.anderson66@gmail.com

If you are interested in volunteering for the 2019 convention, Click on the link below and fill out the online form. This information will be kept private and only shared upon request with the NMRA Meeting & Train Show department.

<http://goo.gl/forms/csKvYd8IRd>

There are opportunities to see a convention in action with the following locations for NMRA National Convention sites:

- 2015: Portland, OR - August 23-30, 2015
- 2016: Indianapolis, IN - July 3-10, 2016
- 2017: Orlando, FL - July 2017
- 2018: Kansas City, MO - Dates pending
- 2019: Salt Lake City, UT - July 7-13, 2019 - Sesquicentennial of the driving of the Golden Spike



Getting the word out can be daunting at times. I have been in the media business for more than thirty years. My job for the Division is to promote the activities of the Northern Utah Division, (such as meeting dates, information about up-coming clinics, etc.) to the magazines, E-publications like Model Railroad Hobbyist, and who ever might have an "audience" of train lovers. Many of these publications work up to four months in advance, meaning if you want to get it in their publication, for say the Sept. 2014 issue, I have to submit the material no later than June 15th as an example.

As you can see, if you have an upcoming clinic or information about a Division activity of any kind, I need to receive it ASAP. Your kind and timely input will be greatly appreciated. Thanks in advance. 😊

Steve Moore,
Division Marketing
kiss@kissmethodinc.com

Treasurer's Report



As of April 11 we have \$5561.53 in the bank with nothing owing.

So far, a total of \$1535.00 has been paid by vendors for tables at Wasatch Rails 2015.

The Club Car



The Northern Utah Division is home to many outstanding modeling clubs, in every scale from Z to Live Steam. You are sure to find at least one of them that will meet your needs, so drop them a line and join the fun!

Contact information is the most recent we have on file. If you have a railroad modeling club in the state of Utah, we would be happy to include your information here. Just send us the name of your club, the scales you support in your club, and how prospective members may contact your club.

[Color Country Model Railroad Club](#) – This multi-scale club is located in the Southern Utah Division in St. George, Utah. Contact Dave Merrill by email at: professordavemerrill@gmail.com

[Color Country T-Trak Club](#) - This N Scale club, located in the Southern Utah Division in St. George, Utah, uses the T-Trak modular system. Contact the club by email at: ColorCountryTTtrak@gmail.com

[Golden Spike American Flyer Train Club](#) – This S scale club meets the third Friday of each month at various club member homes. Their newsletter contains the time and place. Call Jim Buckley by phone at: (801) 252-1921 or by email at: jamesbuckley7@comcast.com

[Golden Spike Train Club of Utah](#) – This club meets Saturday Evenings from 7:00 pm to 11:00 pm, at the Old Children's Museum of Utah (840 N 300 West, SLC). Contact Mark Forslund by phone at (801) 641-6586 for more information.

[Great Basin Lego Train Club](#) – Adult fans of LEGO. Meeting times and club info is posted on their website. Contact Reed Cowan by email at: gbltc@aol.com

HOn3 Club of Northern Utah – Specializing in local narrow gauge railroads in HOn3, this group meets informally and has a layout in Grantsville. Contact Fred Voelcker by email at: fred.voelcker@gmail.com

[Hostlers Model Railroad Club](#) – This Multi-scale club, including live steam, meets the 3rd Wednesday of every month at Ogden's historic Union Station. Contact Mike Murphy by USPS mail at: 752 W 4375 South, Riverdale, UT 84405 or by phone at: (801) 394-4952.

[O Scale 3 Guys](#) – An O and On3 scale club. Contact Alan Badham by USPS mail at 3061 Bonnie Brea Ave, Salt Lake City, UT 84124 or by phone at: (801) 278-1004

[Ophir, Tintic and Western](#) – This 100% NMRA club models in HO and N and meets at the SCERA Theater Boardroom (745 South State Street, Orem) at 7:00 pm on the 3rd Thursday of every month. Contact Larry Carter by email at larrycarter@msn.com or by phone at (801) 446-8161

[Railway & Locomotive Historical Society](#) (Golden Spike Chapter) – An historically oriented group of researchers and preservationists, the Golden Spike chapter of the R&LHS meets at Ogden Station and is presently in the midst of a 20+ year restoration project of the D&RGW #223.

[South Weber Model Railroad Club](#) – This 1-1/2" club runs trains every 3rd Saturday & Sunday at South Weber Canyon Meadows Park. I-84 exit #85, two blocks south, two blocks east.

[Trackers](#) – This HO/HOn3 club meets at the Tooele Railroad Museum (35 N Broadway, Tooele) on Saturdays from 12:00 noon to 4:00 pm (from Memorial Day to Labor Day). During the off-season, club members may meet for maintenance/upgrades to the layout, as weather permits. Contact Cindy Meiser by phone at: (801) 966-7411 or by mail at: 512 Crockett Drive Kearns, Utah 84118

Utah Free-MO – A travelling HO Modular group conforming to the Free-MO standard. Contact Allen Carter by email at: Utahfreemo@aol.com

Utah Garden Railway Society – A "G scale" group dedicated to the art of Garden Railways. Contact Lynn Stringham, President (UGRS) by USPS mail at: 4464 S 4100 West, West Haven, UT 84401

Utah Large Scale Society – A G scale group that meets in various member's homes. Contact Stan White by phone at: (801) 546-4085 or by USPS mail at: 920 N 1550 East, Layton, UT 84040

[Utah Train Collectors Association](#) – Primarily 3-rail O gauge, though other scales are represented. Promotes model railroading in Northern Utah. Meets the last Thursday of each month. Contact Kent Silver (Club President) by email at: webmaster@utahtca.com

Wasatch N Scale Model Railroad Club - Contact Bob Gerald by phone at: (801) 864-0174



Northern Utah Division Officers

Superintendent:	Jack Chase
Assistant Superintendent:	Fred Baney
Treasurer:	Stan Jennings
Director-at-Large:	Jim Wanlass
Director-at-Large:	Steve Moore
Director-at-Large:	Geoff Carter
Director-at-Large:	Blaine Holbrook

Committee Positions

Advertising/Marketing:	Steve Moore
Convention Chairman:	Alan Anderson
Achievement Program:	Jim Wanlass
Division Operations Group (DOG's):	Jack Chase
Clinic Coordinator:	Stan Jennings
Layout Tours:	Pete Harmon
Secretary	Janet Jennings
Newsletter Editor	Rick Luther



Utah's center for model railroading excellence!

Join us every third **Saturday** at the
New Jordan Valley Medical Center West Valley Campus
(Same location as the old Pioneer Valley Hospital)
 from **3:00 PM to 5:00 PM**

at the Hospital's Administrative Conference Room
3460 South Pioneer Parkway in West Valley City
 (4200 West 3500 South)

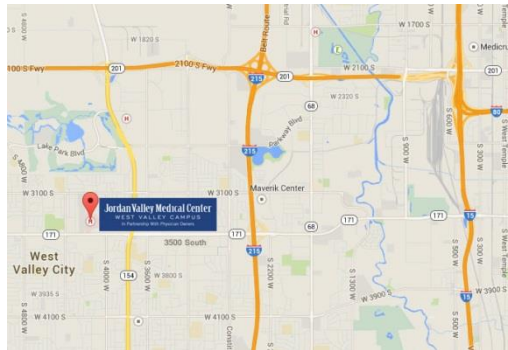

Jordan Valley Medical Center West Valley 3460 Pioneer Parkway, West Valley City Utah 84120

editor@northernutahnmra.org

www.northernutahnmra.org